

Let the imagination happen

ULTRAFILTRATION WATER PURIFIER

User's Manual

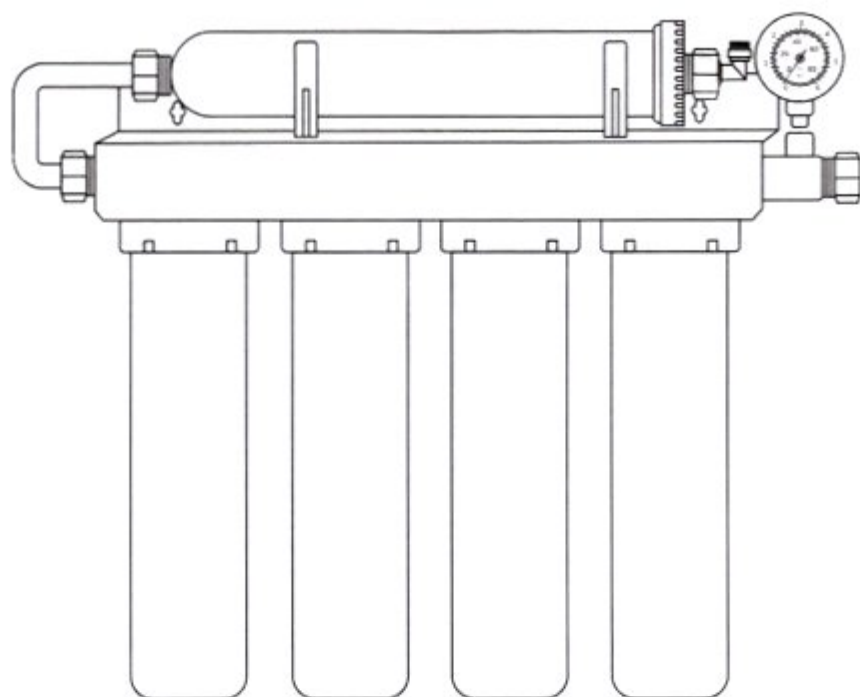

(Five-grade stainless steel classic version)

The final product information is mainly in kind, and the pictures are for reference only.
The company reserves the right of final interpretation and modification.

Respected user

Thank you very much for choosing a high-quality water purifier-UF ultrafiltration series. Please read the instruction manual carefully, it can help you to use it more standardized and reasonable. So that our products can serve you more effectively.

If you have any questions, you can call our company's national unified e-commerce service hotline for consultation Inquiry.

We welcome your valuable comments on our products and services.

Contents

Product Introduction	2
Product parameter	2
Packing List	3
Parts description	3
Configuration and filter replacement time	4
Installation diagram	4
Use provision	5
Exception handling method	6
Warranty description	7
Warranty Card	8

Product Introduction

This product is used to filter and purify municipal tap water, and the effluent quality meets the requirements of Specification for Hygienic Safety and Functional Evaluation of Water Quality Processors-General Water Quality Processors(2001) requirements.

Water production process

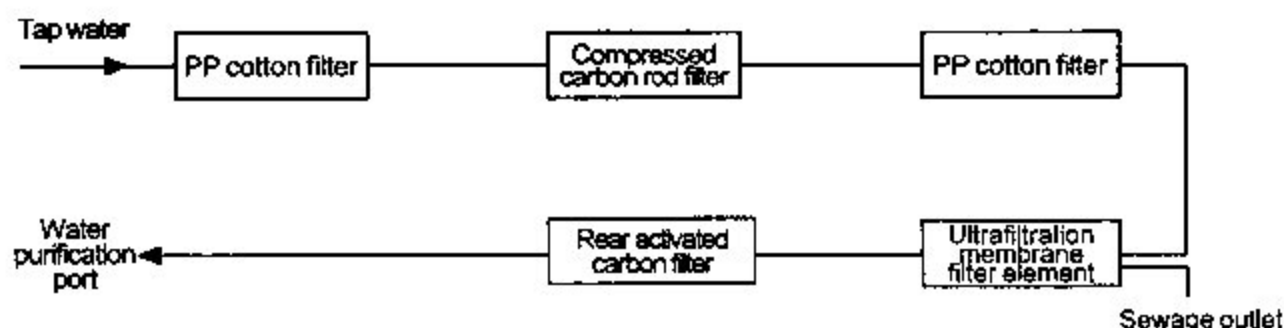

Product parameter

Product number	See label
Purified water flow	2.5L/min
Rated total net water volume	2000L
working principle	Ultrafiltration water purification
Applicable water source	Municipal tap water
Applicable water temperature	5-38℃
Applicable water pressure	0.1-0.4MPa
Executive standard	GB/T4143-2010

Packing List

Accessory name	quantity	Remark
Host	1tower	
Gooseneck faucet	1piece	With mounting gasket
Faucet hanging piece	1piece	
Braided hose	1root	
2 points PE pipe	1roll	
Expansion pin	4piece	
Wall screw	4piece	
Raw material belt	1roll	
Water inlet tee	1piece	
manual	1Book	
2 points through	1piece	
wrench	1Bundle	
Residual chlorine test agent	1bottle	

Note: The list is subject to the actual product, subject to change without notice!

Parts description

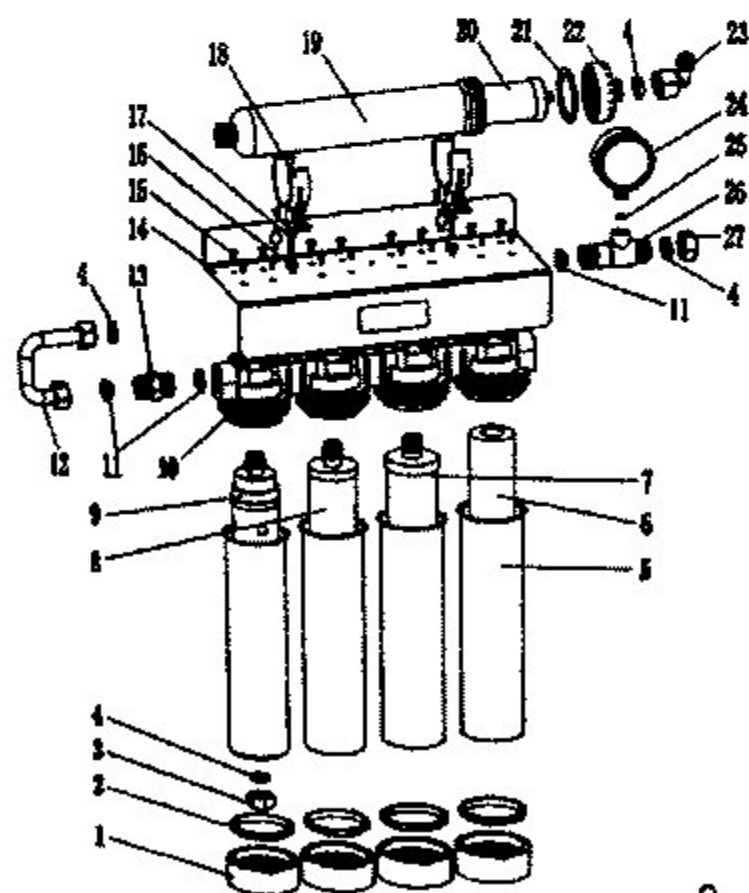

1. Filter bottle fixing ring	15.M4 stainless steel screw
2. Filter bottle sealing ring	16.M5 hex nut
3.4 points copper plug	17.M5 hexagon socket screw
4 points gasket	18.45 Angle clamp
5. Stainless steel filter bottle	19. Rear activated carbon filter bottle
6.PP cotton filter	20. Rear activated carbon filter
7. Compressed carbon filter element	21. Rear activated carbon sealing ring
8. PP cotton filter	22. Rear activated carbon filter bottle screw cap
9. Ultrafiltration membrane filter element	23.4 turn 2 minutes quick connect elbow
10. Integrated waterway board	24. Pressure gauge
11.T type 4 points gasket	25. Pressure gauge sealing ring
12. Stainless steel elbow	26. Internal and external teeth reducing tee
13.4 points straight connector	27.4 points plastic plug
14. Hanging board	

Configuration and filter replacement time

PP cotton filter: pre-treat the incoming raw water; effectively filter most of the colloids, impurities, silt, rust, large particles and other impurities in the tap water. (According to different water quality, it is recommended to replace in 3–6 months)

Compressed carbon filter element: Absorb different colors and odors and residual chlorine in the water to improve the taste of the water. (According to different water quality, it is recommended to replace in 6–10 months)

PP cotton filter: pre-treat the incoming raw water; effectively filter most of the colloids, impurities, silt, rust, large particles and other impurities in the tap water. (According to different water quality, it is recommended to replace in 3–6 months)

Ultrafiltration membrane filter element: the hollow fiber membrane ultrafiltration element is used, and the ultrafiltration pores are less than 0.01 microns, and the suspended solids, colloids, particles, and other impurities greater than 0.01 microns in the water are intercepted (recommended to be replaced in 12–24 months according to different water quality)

Post activated carbon filter: strong adsorption capacity, further effectively remove the different colors in the tap water. Peculiar smell, residual chlorine, etc., improve the taste of water. (According to different water quality, it is recommended to replace in 6–10 months)

Installation diagram

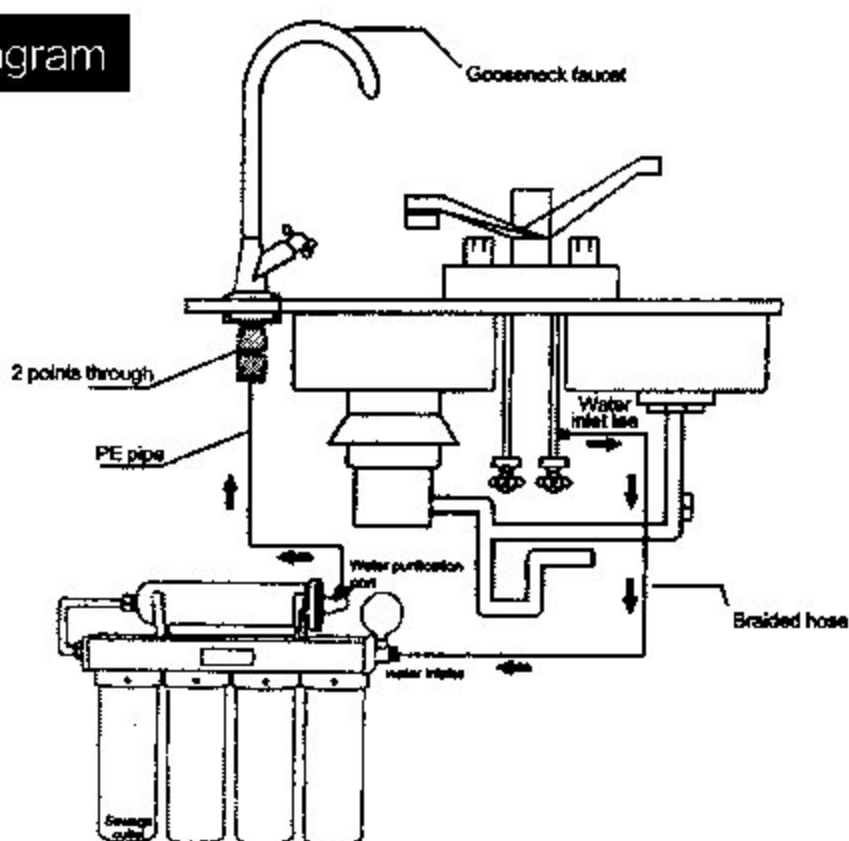

Notice

- Please install it according to your style. The shells are all affixed with: water inlet, sewage outlet, and water purifier. Please install according to the nozzle mark. When the water purifier is in normal use, be sure to close the sewage ball valve, Avoid unnecessary waste. Please close the three-way valve when going out for a long time.

Use reminder

1. Please turn off the water purifier faucet before leaving, otherwise the company will not take any responsibility for the loss of water leakage.
2. Please confirm that the water temperature is between 5–38°C.
3. Please install it in a place with a floor drain (sewer).
4. This product is only suitable for water purification of municipal tap water.
5. Strictly follow the instructions to ensure the correct connection of the water purification system.
6. When using the water purifier for the first time, rinse the drain for 5–10 minutes, and then turn on the water purifier faucet. Rinse for 5–10 minutes before normal use.
7. If the water output becomes smaller, you can open the sewage outlet to rinse for 10 minutes, if the water purifier is not used for a long time, before use. The water purifier should be rinsed for 5 minutes to ensure your normal use and prolong the use of the product.
8. It is recommended to buy our company's accessories. Our company does not take any responsibility.
9. If there are white floating or sediments after the purified water is boiled, it is beneficial to calcium and magnesium ion oxides, because the raw water has high hardness, which is normal.
10. Please measure and make sure the tap water pressure is 0.1–0.4MPa before installation, and when it is higher than 0.4MPa, please install a pressure reducing valve; when the water pressure is too low, install a booster pump to ensure your normal use.
11. If the raw water has a lot of silt and rust, you can install a sedimentation filter or pre-treatment before entering the water. To ensure the safe use of the water purifier.
12. When using the water purifier, be sure to close the sewage outlet to avoid unnecessary waste.

Exception handling method

problem	Possible Causes	Approach
Water production has dropped a lot	The filter element is clogged	Need to flush or replace the filter element, please contact e-commerce customer service
	The filter element is not replaced in time	Please contact the e-commerce customer service to replace the filter element in time
	The ball valve or faucet does not open safely	Check whether the three-way ball valve or faucet is safely opened
Poor effluent quality	Filter element failure	Please contact the e-commerce customer service to replace the filter element in time
	Long-term deactivation (deactivation time>3 days)	Rinse for 5-10 minutes
water leakage	Poor water quality	Confirm that the water source is municipal tap water
	Damaged parts	Please cut off the water source and contact the e-commerce customer service, or call the after sales phone

Warranty description

According to the "New Three Guarantees", the warranty period of the whole machine is one year (calculated from the date of issuance of the invoice) (warranty scope)(For family use only).

1. During the warranty period, for any faults caused by the quality of the product itself, please refer to the completed "Product WarrantyRepair certificate" and purchase invoice are repaired free of charge at special repair outlets across the country or contact e-commerce customer service.
2. Please keep the purchase invoice and warranty certificate together as a warranty certificate. Once the invoice is altered, The warranty expires immediately.
3. Customers who have passed the warranty period, if they need to order product parts and accessories by mail, can contact the customer service department of our company. It can also be purchased at local outlets.
4. If the warranty period is promised in the manual, the manual shall prevail. The following situations will not be repaired free of charge:
 - a. There is no three guarantee certificate and valid invoice.
 - b. Failure caused by operating the machine not in accordance with the requirements of the manual.
 - c. One of the following conditions is not covered by the warranty:
 - ◇ Damage caused by improper use, storage and maintenance by consumers.
 - ◇ Damage caused by non-designated maintenance department of the company assembling, disassembling and repairing by itself.
 - ◇ Damage caused by force majeure.
 - d. For products that are not covered by the warranty, the company's customer service department will still serve you enthusiastically.

Warranty Card

Product name article number		Body number	
--------------------------------	--	-------------	--

Purchase date	Buy store	contact number	
			Dealer stamp

Customer name	
Customer address	
Customer phone	
Postal code	

Maintenance records

~Healthy water every day~